

# HORIZON II

## RECESSED MEDICINE CABINET

SKU: 912093

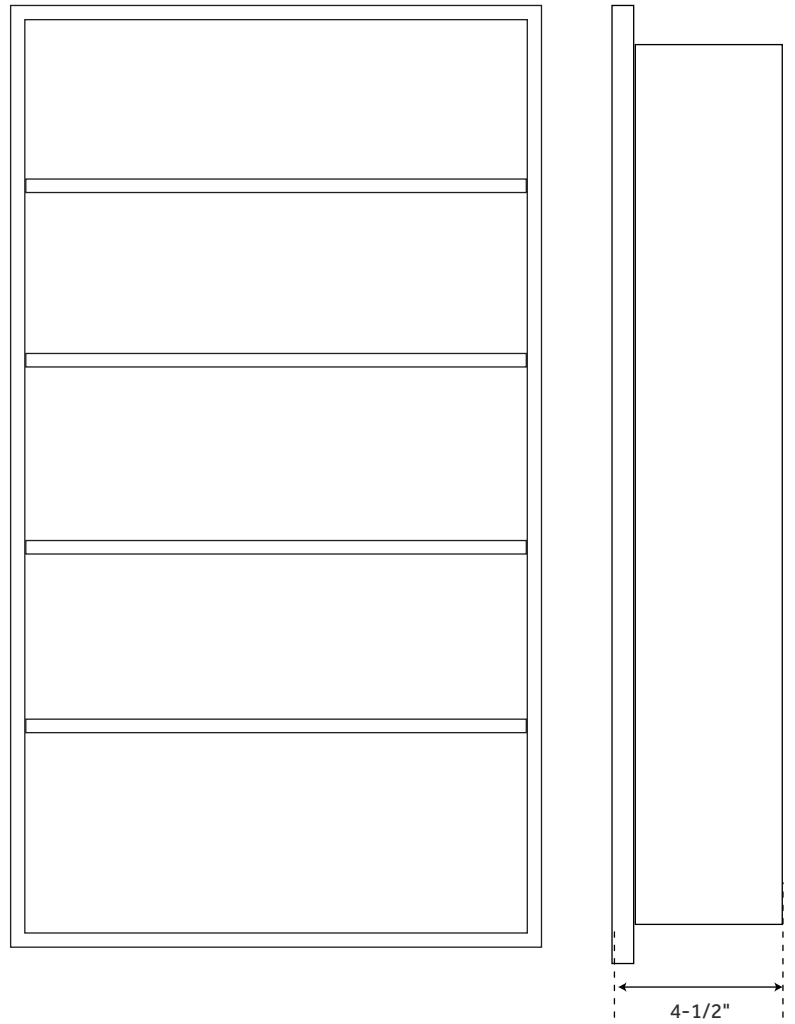
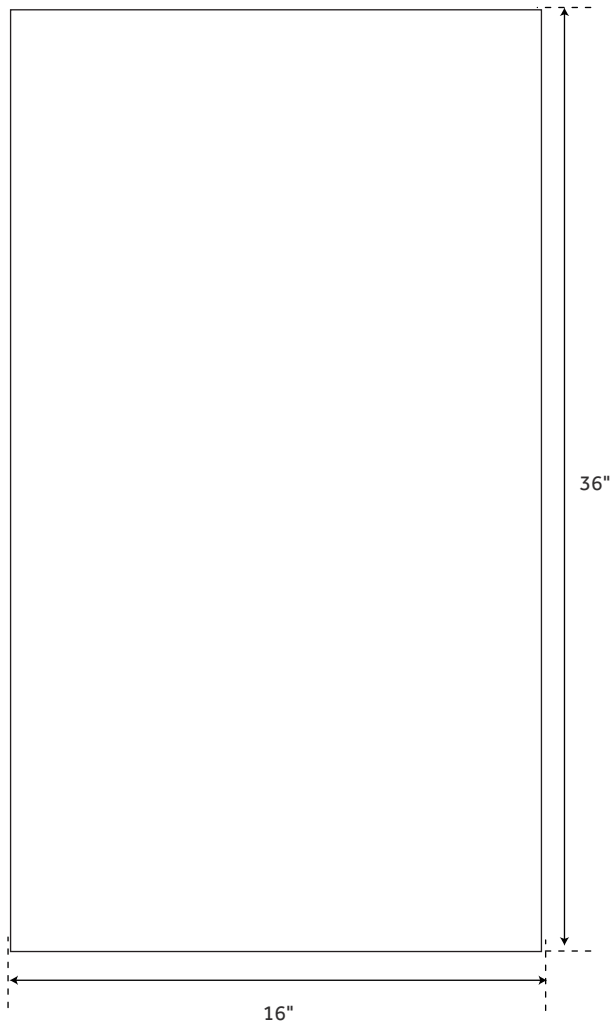

### FEATURES

Product Finish: White Powder Coat  
Features: Frameless, Mirrored  
Material: Steel  
Design: Transitional  
Mirror Shape: Rectangle  
Number of Doors: 1  
Width: 16"  
Height: 36"  
Depth: 4-1/2"  
Mounting Hardware Included: Yes  
Assembly Required: No  
Number of Shelves: 4  
Adjustable Shelves: Yes

### SIGNATURE HARDWARE LIFETIME WARRANTY

See website for warranty information



REVISED 09/27/2018